

Eyelet connectors Ball joints/swivel nozzle holders

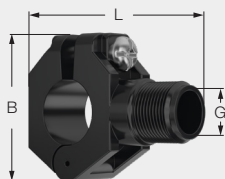

Eyelet connectors



Designation	Pipe dia.	Thread G	B [mm]	L [mm]	Material	Order no.
Eyelet connector, single, max. 10 bar, with stainless-steel screw	3/8"	G 3/8 male	41	49	Polyamide	090.053.51.00.00
	1/2"	G 3/8 male	45	53	Polyamide	090.003.51.00.00
	3/4"	G 3/8 male	51	57	Polyamide	090.013.51.00.00
	1"	G 3/8 male	61	65	Polyamide	090.023.51.00.00

Ball joints

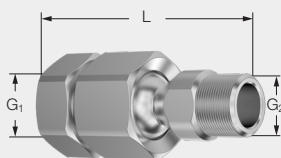

Designation	Thread G ₁	Thread G ₂	L [mm]	Material	Order no.
Ball joint with threaded connection max. 25 bar, full-swivel type max. 30°	G 3/8 female	G 3/8 male	56	Brass	092.022.30.AF.00
	G 1/2 female	G 1/2 female	71	Brass	092.040.30.AH.00
	G 3/4 female	G 3/4 female	80	Brass	092.050.30.AL.00

Swivel nozzle holders

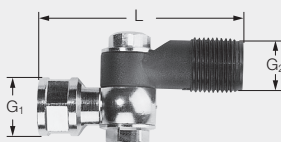

Accessories for swivel nozzle



Threaded cap G 3/8



Gasket

Designation	Thread G ₁	Thread G ₂	L [mm]	Material	Accessories	Order no.
Swivel nozzle holder max. 20 bar, swivel function in one plane	G 1/4 male	G 3/8 male	35	Polyamide		095.016.56.07.22
	1/4" NPT female	G 3/8 male	35	Polyamide		095.016.56.07.21
			–	POM	incl. threaded cap G 3/8	065.200.56.00.00
			–	Rubber	incl. gasket	065.240.73.00.00

Double swivel nozzle holders

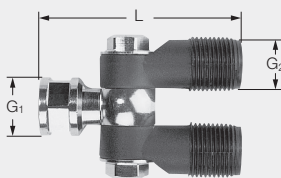

Accessories for double swivel



Threaded cap G 3/8



Gasket

Designation	Thread G ₁	Thread G ₂	L [mm]	Material	Accessories	Order no.
Double swivel nozzle holder max. 20 bar	1/4" NPT female	G 3/8 male	35	Polyamide		095.016.56.07.20
			–	POM	incl. threaded cap G 3/8	065.200.56.00.00
			–	Rubber	incl. gasket	065.240.73.00.00