

# Rotating cleaning nozzle MicroSpinner 2 Series 5M2



## Features:

- Hygienic design
- Suitable for high temperatures
- Made entirely of stainless steel 316L or Alloy 22



**ATEX version available on request**

Series 5M2

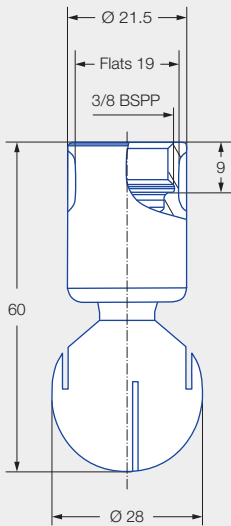

Female thread

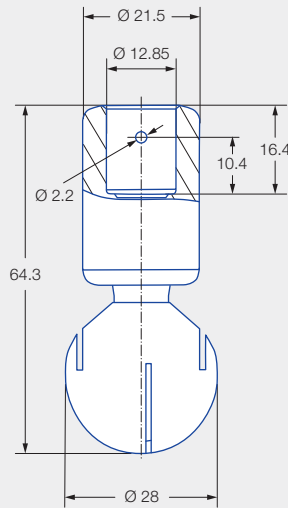

Dimensions of the slip-on connection according to ASME-BE (OD-tube)

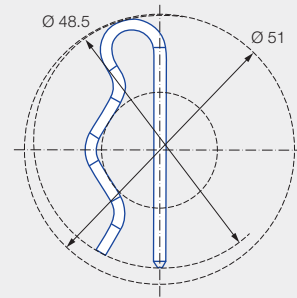

Dimensions of the slip-on connection top view stainless steel 316L

Dimensions of the slip-on connection top view Alloy 22

Max. tank diameter [m]	0	1	2	3	4	5	6	7	8	9
------------------------	---	---	---	---	---	---	---	---	---	---



**Cleaning efficiency class**  
2



**Max. temperature**  
250 °C



**Installation**  
Operating in every direction possible



**Bearing**  
Double ball bearing made of stainless steel 316L, Alloy 22



**Material**  
Stainless steel 316L, Alloy 22



**Recommended operating pressure**  
2 bar



**Filtration**  
Line strainer with a mesh size of 0,1mm/170 mesh





**Adapter**  
3/8 BSPP is compatible with HygienicFit



**Function video**  
[www.lechler.com/de-en/medialibrary](http://www.lechler.com/de-en/medialibrary)  
Or scan the QR Code.

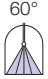

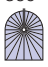
Spray angle	Ordering no.					Narrowest free cross section $\varnothing$ [mm]	$\dot{V}$ water [l/min]				Max. tank diameter [m]
	Type	Material no.		Connection			$p$ [bar] ( $p_{\max} = 7$ bar)				
		1Y	21	3/8 BSPP	1/2" Slip-on		1.0	2.0	3.0	at 40 psi [US gal/min]	
 60°	5M2.952	●	●			AF	TF05	1.5	16	23	28
	5M2.042	●	●	AF	TF05	3.0	28	40	49	12	–
 180°	5M2.004	●	●	AF	TF05	0.9	22	32	39	10	1.8
 360°	5M2.969	●	●	AF	TF05	0.8	18	25	31	8	1.7
	5M2.049	●	●	AF	TF05	0.9	28	39	48	12	1.8

NPT thread, weld-on and further slip-on versions on request.

The max. tank diameter shown above applies for the recommended operating pressure and has to be seen as a recommendation. The cleaning result is also affected by the type of soiling.

Operating with compressed air only for short-term usage. Operation above the recommended operating pressure has negative effects on the cleaning result and wear.

#### Information slip-on connection

- Pin made of stainless steel 316L included (Ordering-no. 05M.230.1Y.00.00.0). Version made of Alloy 22 bolt with head incl. pin included (Ordering-no. 05M.231.21.00.00.0).
- Depending on diameter of the adapter, the flow rate increase due to leakage between connecting pipe and rotating cleaning nozzle.
- Minimum insertion diameter (with mounted pin) is 48,5 mm for the types made of stainless steel 316L and 28 mm for the types made of Alloy 22.

Example    Type    +    Connection    =    Ordering no.  
of ordering: 5M2.952.1Y    +    AF    =    5M2.952.1Y.AF