

ENGINEERING  
YOUR SPRAY SOLUTION



**WSV WaterStop Valve**  
for **SCALEMASTER®** Nozzles



**WaterStop Valve**

# WSV Water Stop Valve – features and benefits

## The problem

The use of low water pressure pre-fill function is a standard feature in a modern descaling system in order to eliminate hydraulic shock (water hammers) when initiating high pressure spraying through an open header.

However, the low pressure water continuously charged through the open descaling nozzles can cause undesired metallurgical effects due to the uncontrolled cooling especially when rolling critical plates (API-pipe or stainless steel grades) during a »Thermo Mechanical Control Process« (TMCP).

## The solution

The installation of the new Lechler WSV Water Stop Valve for SCALEMASTER® descaling nozzles in front of every nozzle prevents a water flow through the nozzles below a water pressure of 10, respectively 5 bar.

## The features

- The WSV is a check valve which includes the stabilizer
- Every WSV comes with a filter
- Material completely made from stainless steel
- Metallic sealing
- Piston hardened

## The advantages and benefits

- No significant changes of nozzle spray characteristics (width, thickness, liquid distribution)
- No modifications of header required
- Available for nozzle series SCALEMASTER®, MiniSCALEMASTER®, SCALEMASTER® HP and MiniSCALEMASTER® HP
- Very large internal free passages for clogging free operation
- Simple design, all four components easy to replace
- Field Test approved
- Long service life



# WSV Water Stop Valve Technical Data

This page shows the components and basic technical data of the WSV Water Stop Valve.  
For further information please do not hesitate to contact us.

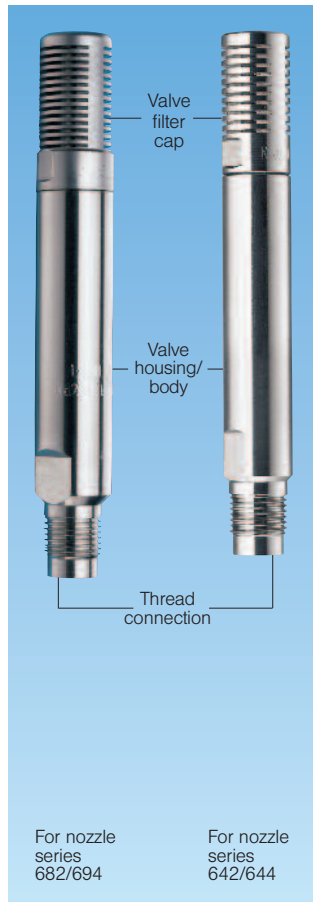
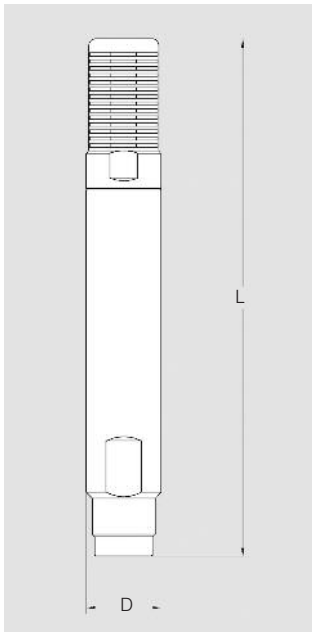

WSV Water Stop Valve

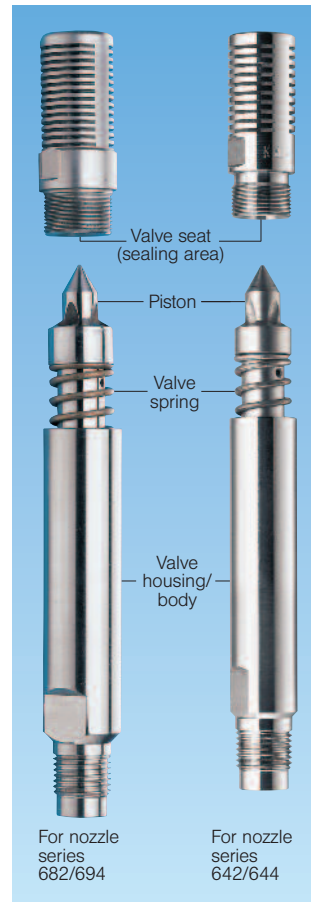

WSV Water Stop Valve, components

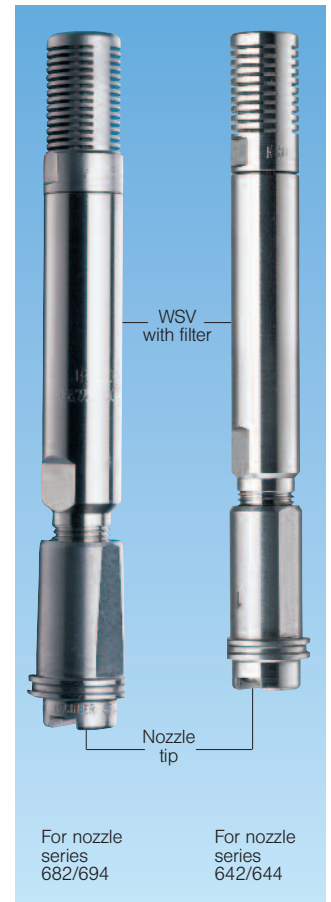

WSV Water Stop Valve, mounted with nozzle

## Technical Data

For use in combination with nozzle series	Ordering number	Opening pressure [mm]	Closing pressure [bar]	Filter slit width [mm]	L [mm]	D [mm]	G	Weight [g]	Material
SCALEMASTER® 694	069.422.1E.01.00.0	8	5	1	148	21,5	M18x1	242	Stainless steel
	069.422.1E.00.00.1	14	10	1	148	21,5	M18x1	242	Stainless steel
SCALEMASTER® HP 682	068.220.1E.01.00.0	8	5	1	148	21,5	M16x1,5	242	Stainless steel
	068.220.1E.00.00.1	14	10	1	148	21,5	M16x1,5	242	Stainless steel
MiniSCALEMASTER® 644	064.423.1E.01.00.0	8	5	1	140	18,8	M16x1	176	Stainless steel
	064.423.1E.00.00.0	14	10	1	140	18,8	M16x1	176	Stainless steel
MiniSCALEMASTER® HP 642	064.223.1E.01.00.0	8	5	1	140	18,8	M16x1,5	176	Stainless steel
	064.223.1E.00.00.0	14	10	1	140	18,8	M16x1,5	176	Stainless steel



## WSV Water Stop Valve Assembly with SCALEMASTER® nozzles

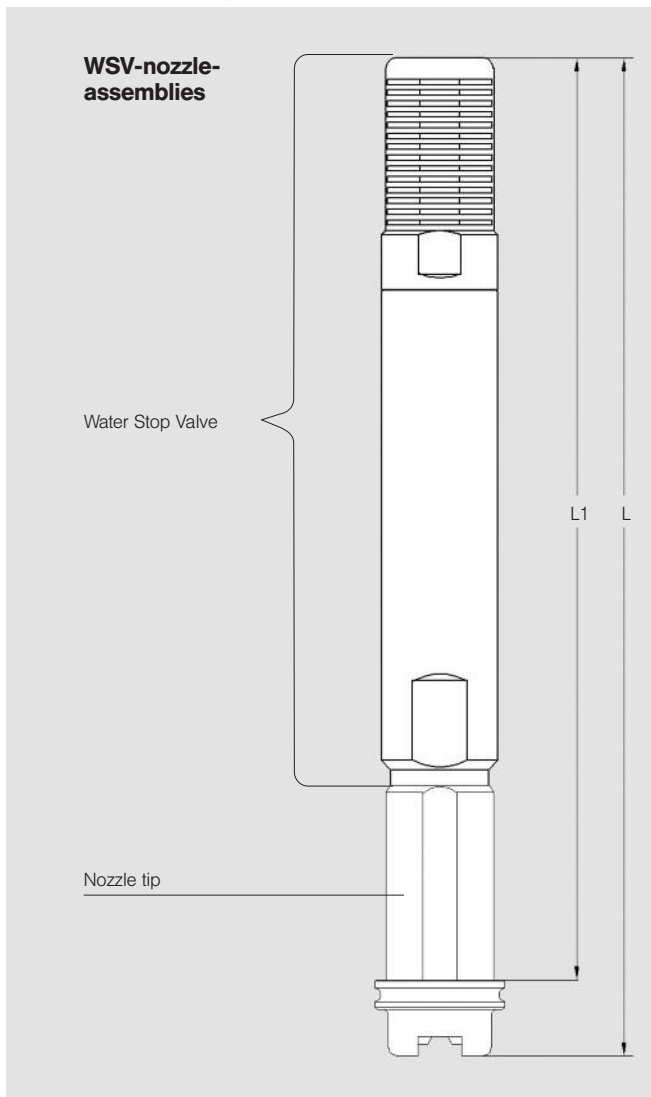

Nozzle series	WSV Ordering number	L [mm]	L1 [mm]
SCALEMASTER® 694	069.422.1E.01.00.0	170	156
	069.422.1E.00.00.1	170	156
SCALEMASTER® HP 682	068.220.1E.01.00.0	185	171
	068.220.1E.00.00.1	185	171
MiniSCALEMASTER® 644	064.423.1E.01.00.0	162	148
	064.423.1E.00.00.0	162	148
MiniSCALEMASTER® HP 642	064.223.1E.01.00.0	177	163
	064.223.1E.00.00.0	177	163

### Lechler GmbH · Precision Nozzles · Nozzle Systems

P.O. Box 13 23 · 72544 Metzingen, Germany · Phone +49 71 23 962-0 · Fax +49 71 23 962-333 · info@lechler.de · www.lechler.com

**Belgium:** Lechler S.A./N.V. · Avenue Mercatorlaan, 6 · 1300 Wavre · Phone: +32 10 225022 · Fax: +32 10 243901 · info@lechler.be

**China:** Lechler Intl. Trad. Co. Ltd. · Beijing · Rm. 418 Landmark Tower · No. 8 Dong San Huan Bei Lu · Phone: +86 10 84537968, Fax: +86 10 84537458 · info@lechler.com.cn

**Finland:** Lechler Oy · Jämspilänkatu 18 · 04360 Kerava · Phone: +358 207 856880 · Fax: +358 207 856881 · info@lechler.fi

**France:** Lechler France, S.A. · Bât. CAP2 · 66-72, Rue Marceau · 93558 Montreuil cedex · Phone: +33 1 49882600 · Fax: +33 1 49882609 · info@lechler.fr

**Great Britain:** Lechler Ltd. · 1 Fell Street, Newhall · Sheffield, S9 2TP · Phone: +44 114 2492020 · Fax: +44 114 2493600 · info@lechler.com

**India:** Lechler (India) Pvt. Ltd. · Plot B-2 · Main Road · Wagle Industrial Estate · Thane (W) · 400604 · Phone: +91 22 40634444 · Fax: +91 22 40634497 · lechler@lechlerindia.com

**Italy:** Lechler Spray Technology S.r.l. · Via Don Dossetti, 2 · 20080 Carpiano (Mi) · Phone: +39 02 98859027 · Fax: +39 02 9815647 · info@lechleritalia.com

**Sweden:** Lechler AB · Kungsängsvägen 31 B · 753 23 Uppsala · Phone: +46 54 137030 · Fax: +46 54 137031 · info@lechler.se

**Spain:** Lechler S.A. · Avda. Pirineos 7 · Oficina B7, Edificio Inbisa I · 28700 San Sebastián de los Reyes, Madrid · Phone: +34 91 6586346 · Fax: +34 91 6586347 · info@lechler.es

**USA:** Lechler Inc. · 445 Kautz Road · St. Charles, IL 60174 · Phone: +1 630 3776611 · Fax: +1 630 3776657 · info@lechlerUSA.com